



D

## FASCIA wall collection

**DESCRIPTION:** Base and Structural block single-sided & double-sided **TEXTURE:** Smooth

### SINGLE-SIDED

#### Specifications per pallet



96 units / pallet

	Imperial	Metric
Product dimension (L x D x H)	7 7/8 x 9 1/4 x 5 7/8	200 x 235 x 150
Cubing	96 units	96 units
	31.00 ft <sup>2</sup>	2.88 m <sup>2</sup>
	62.99 lin. ft	19.20 lin. m
Approx. Weight	2 612 lbs	1 185 kg
Number of rows	4	
Coverage per row	7.75 ft <sup>2</sup>	0.72 m <sup>2</sup>
Linear coverage per row	15.75 lin. ft	4.80 lin. m

### Pallet Overview - single-sided

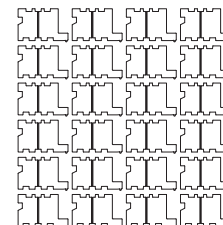

### DOUBLE-SIDED

#### Specifications per pallet

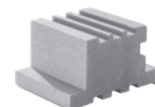

72 units / pallet

	Imperial	Metric
Product dimension (L x D x H)	7 7/8 x 11 1/6 x 5 7/8	200 x 281 x 150
Cubing	72 units	72 units
	23.25 ft <sup>2</sup>	2.16 m <sup>2</sup>
	47.24 lin. ft	14.40 lin. m
Approx. Weight	2 138 lbs	970 kg
Number of rows	4	
Coverage per row	5.81 ft <sup>2</sup>	0.54 m <sup>2</sup>
Linear coverage per row	11.81 lin. ft	3.60 lin. m

### Pallet Overview - double-sided

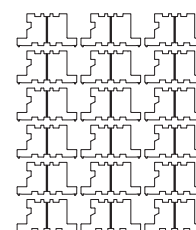

### BASE

#### Specifications per pallet

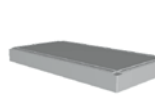

66 units / pallet

	Imperial	Metric
Product dimension (L x D x H)	23 5/8 x 12 x 2 3/8	600 x 305 x 60
Cubing	66 units	66 units
	25.58 ft <sup>2</sup>	2.38 m <sup>2</sup>
	129.92 lin. ft	39.60 lin. m
Approx. Weight	3 701 lbs	1 679 kg
Number of rows	11	
Coverage per row	2.33 ft <sup>2</sup>	0.22 m <sup>2</sup>
Linear coverage per row	11.81 lin. ft	3.60 lin. m

### Pallet Overview - base

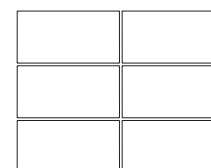

The top of Fascia Panels shall not be left exposed, they must be stabilized with a structural block on top or glued to the cap.

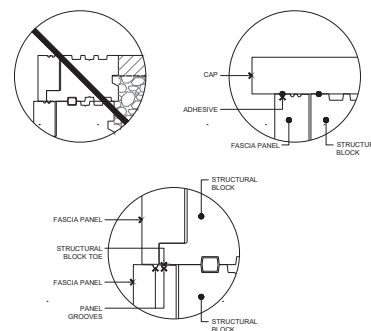

## NOTES

See page 6 for icons description.

### COMPATIBLE CAPS

See page 145 for product compatibility..

See page 146 to 161 for more technical information.



## ROSEMONT Fascia wall collection

**DESCRIPTION:** Fascia Panel & Corner **TEXTURE:** Klean-Bloc Slate



### FASCIA

#### Specifications per pallet

	Imperial	Metric
 Product dimension (L x D x H)	26 x 2 3/4 x 5 7/8	660 x 70 x 150
42 units / pallet	42 units	42 units
Cubing	44.75 ft <sup>2</sup>	4.16 m <sup>2</sup>
	90.94 lin. ft	27.72 lin. m
Approx. Weight	1 240 lbs	562 kg
Number of rows	7	
Coverage per row	6.39 ft <sup>2</sup>	0.60 m <sup>2</sup>
Linear coverage per row	13.03 lin. ft	3.96 lin. m

### CORNER

#### Specifications per pallet

	Imperial	Metric
 Product dimension (L x D x H) <b>A</b>	23 1/4 x 2 3/4 x 5 7/8	590 x 70 x 150
 Product dimension (L x D x H) <b>B</b>	23 1/4 x 2 3/4 x 5 7/8	590 x 70 x 150
Cubing	24 units	24 units
Approx. Weight	660 lbs	299 kg
Number of rows	4	
Pillar height	35 7/16 in	900 mm

Left unit  
12 units / pallet

Right unit  
12 units / pallet

#### Pallet Overview - panels

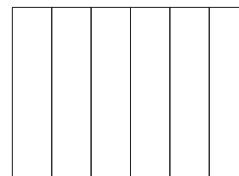

#### Pallet Overview - corners

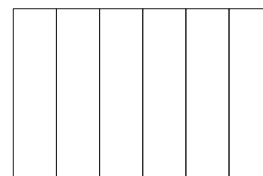

The top of Fascia Panels shall not be left exposed, they must be stabilized with a structural block on top or glued to the cap.

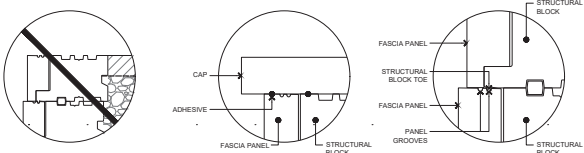

Rock Garden Brown

Klean-Bloc  
Slate



Riviera

Klean-Bloc  
Slate



Azzurro

Klean-Bloc  
Slate

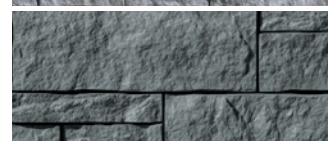

## NOTES

See page 6 for icons description.

### COMPATIBLE CAPS

See page 145 for product compatibility.

See page 146 to 161 for more technical information.

Fascia Panels require single-sided structural blocks (retaining wall application) or double-sided structural blocks (freestanding walls).  
Sold Separately.

# INSTALLATION GUIDE

## FREESTANDING WALL

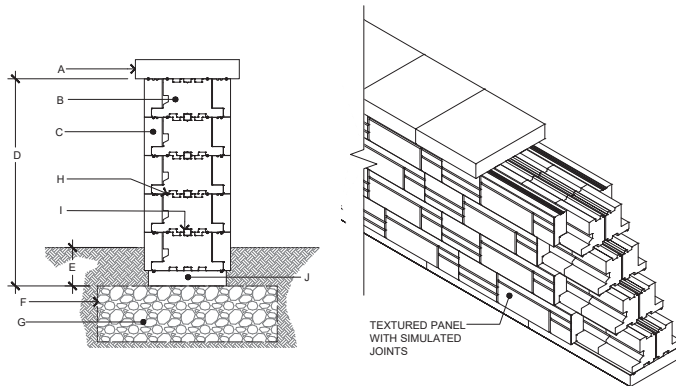

- A. TECO-BLOC CAP UNIT SECURED TO CORE AND PANEL BELOW WITH CONCRETE ADHESIVE
- B. STRUCTURAL BLOCK DOUBLE-SIDED UNIT
- C. PANEL UNIT
- D. 29 1/2" (750 mm) MAX.
- E. EMBEDMENT DEPTH 6" (150 mm) MIN.
- F. GEOTEXTILE
- G. COMPACTED GRANULAR BASE 6" (150 mm) MIN. THICKNESS ACCORDING TO PROJECT SPECIFICATIONS
- H. CONCRETE ADHESIVE
- I. HDPE HORIZONTAL KEY
- J. BASE UNIT

## FREESTANDING WALL - 90° CORNER

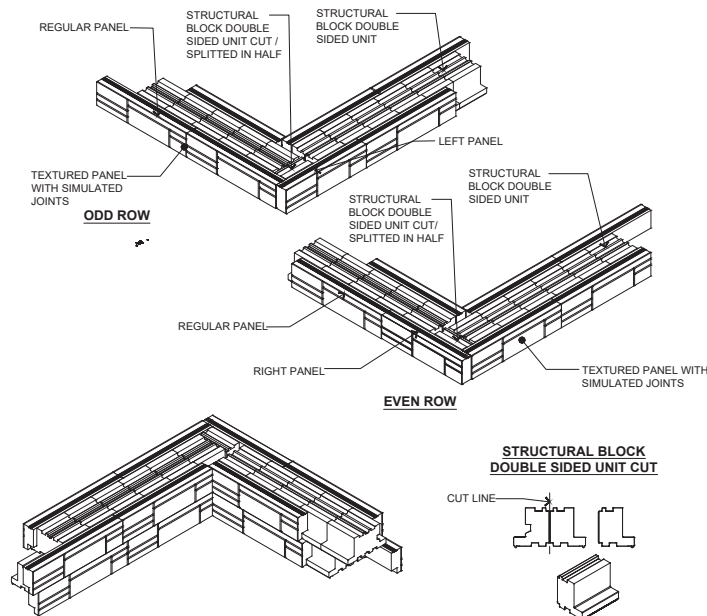

1. ALTERNATE ODD AND EVEN ROWS.
2. STAGGER STRUCTURAL BLOCKS JOINTS FROM ONE ROW TO THE NEXT.
3. GLUE ALL STRUCTURAL BLOCKS AT EACH ROW WITH CONCRETE ADHESIVE.
4. APPLY CONCRETE ADHESIVE ON TOP OF UPPERMOST PANEL UNITS TO FIX CAP UNITS.
5. STRUCTURAL BLOCK DOUBLE SIDED UNIT CUT / SPLITTED IN HALF MUST ALWAYS BE PRESENT AT THE CORNER OF THE WALL.

**NOTE:**

The top of Fascia Panels shall not be left exposed, they must be stabilized with a structural block on top or glued to the cap.

## GRAVITY RETAINING WALL

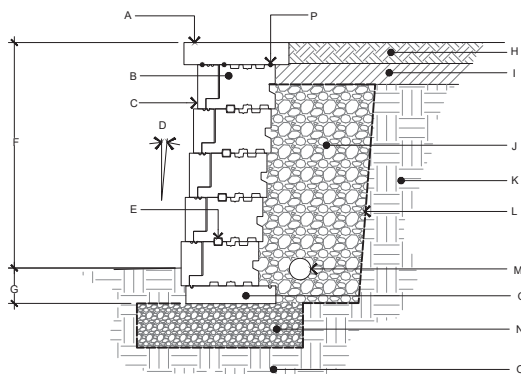

- A. TECO-BLOC CAP UNIT SECURED TO UNIT BELOW WITH CONCRETE ADHESIVE
- B. STRUCTURAL BLOCK SINGLE SIDED UNIT
- C. PANEL UNIT
- D. WALL INCLINATION (5.3°)
- E. HDPE HORIZONTAL KEY
- F. EXPOSED HEIGHT
- G. EMBEDMENT DEPTH
- H. TOP SOIL
- I. LOW PERMEABILITY SOIL
- J. 3/4" (20 mm) CLEAN STONE 14" (350mm) THICK MIN.
- K. RETAINED SOIL
- L. GEOTEXTILE
- M. PERFORATED DRAIN
- N. LEVELING PAD
- O. FOUNDATION SOIL
- P. CONCRETE ADHESIVE
- Q. BASE UNIT

# INSTALLATION GUIDE

## FREESTANDING END OF A STRAIGHT WALL (OPTION 1)

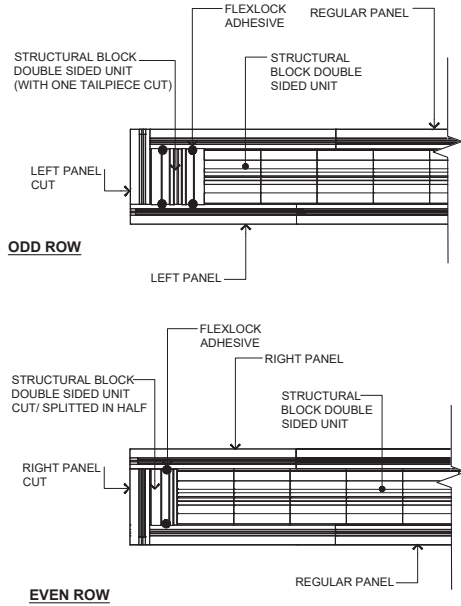

- NOTES:
1. ALTERNATE ODD AND EVEN ROWS.
  2. STAGGER STRUCTURAL BLOCKS JOINTS FROM ONE ROW TO THE NEXT.
  3. GLUE ALL STRUCTURAL BLOCKS AT EACH ROW WITH FLEXLOCK ADHESIVE.
  4. APPLY FLEXLOCK ADHESIVE ON TOP OF UPPERMOST PANEL UNITS TO FIX CAP UNITS.

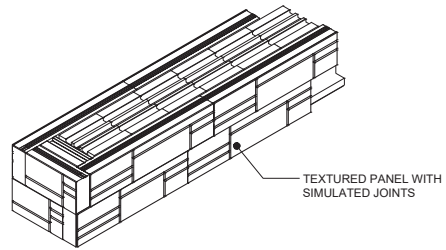

**NOTE:**  
The top of Fascia Panels shall not be left exposed, they must be stabilized with a structural block on top or glued to the cap.

## FREESTANDING END OF A STRAIGHT WALL (OPTION 2)

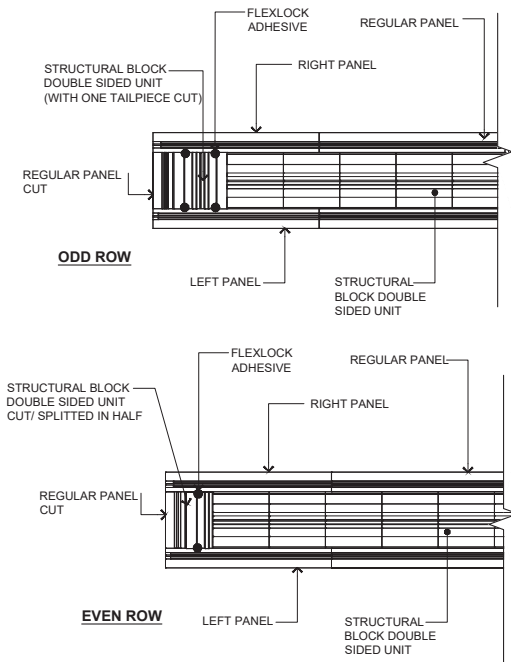

- NOTES:
1. ALTERNATE ODD AND EVEN ROWS.
  2. STAGGER STRUCTURAL BLOCKS JOINTS FROM ONE ROW TO THE NEXT.
  3. GLUE ALL STRUCTURAL BLOCKS AT EACH ROW WITH FLEXLOCK ADHESIVE.
  4. APPLY FLEXLOCK ADHESIVE ON TOP OF UPPERMOST PANEL UNITS TO FIX CAP UNITS.

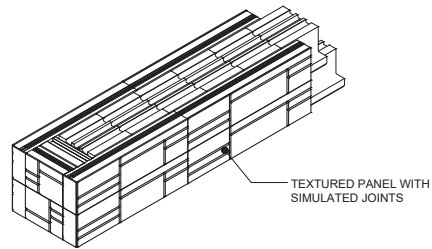

# INSTALLATION GUIDE

## PILLARS - FASCIA WALL COLLECTION

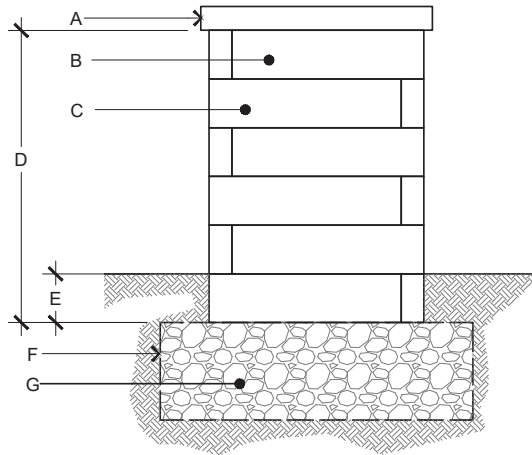

### **STRUCTURAL BLOCK SINGLE SIDED UNIT CUT / SPLITTED IN HALF**

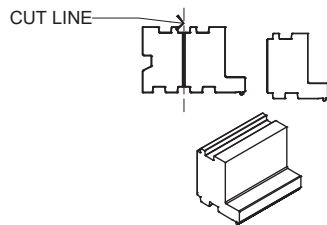

- A. PILLAR CAP UNIT SECURED TO CORE AND PANEL BELOW WITH CONCRETE ADHESIVE
- B. RIGHT PANEL
- C. LEFT PANEL
- D. 35 7/8" (900 mm) MAX HEIGHT
- E. EMBEDMENT DEPTH 6" (150 mm) MIN.
- F. GEOTEXTILE
- G. COMPACTED GRANULAR BASE 6" (150 mm) MIN. THICKNESS ACCORDING TO PROJECT SPECIFICATIONS.

**NOTE:**

The top of Fascia Panels shall not be left exposed, they must be stabilized with a structural block on top or glued to the cap

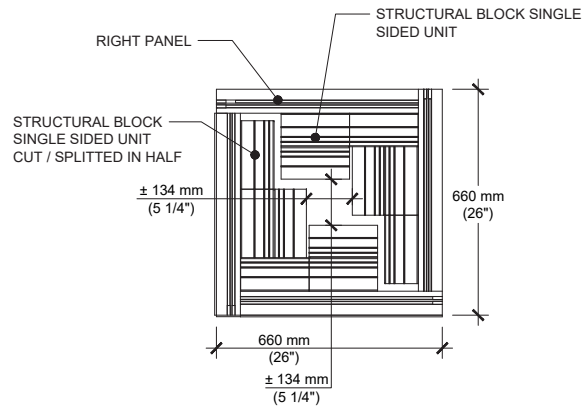

**ODD ROW**

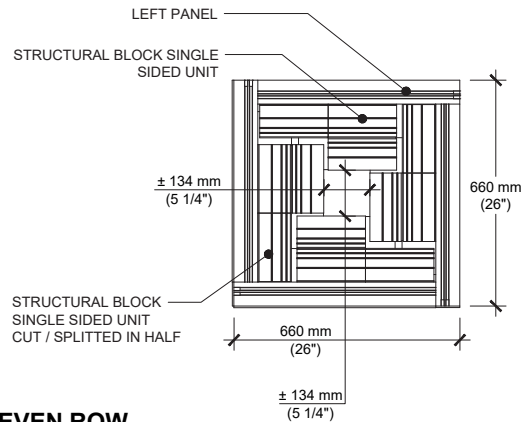

**EVEN ROW**

IIN.

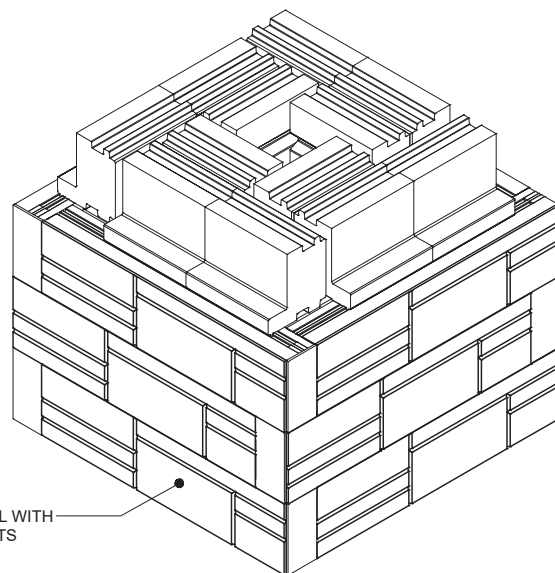

TEXTURED PANEL WITH SIMULATED JOINTS

For all possible combinations of pillars and caps, please refer to the correspondence table on page 145

# INSTALLATION GUIDE

## STEPS - FASCIA WALL COLLECTION

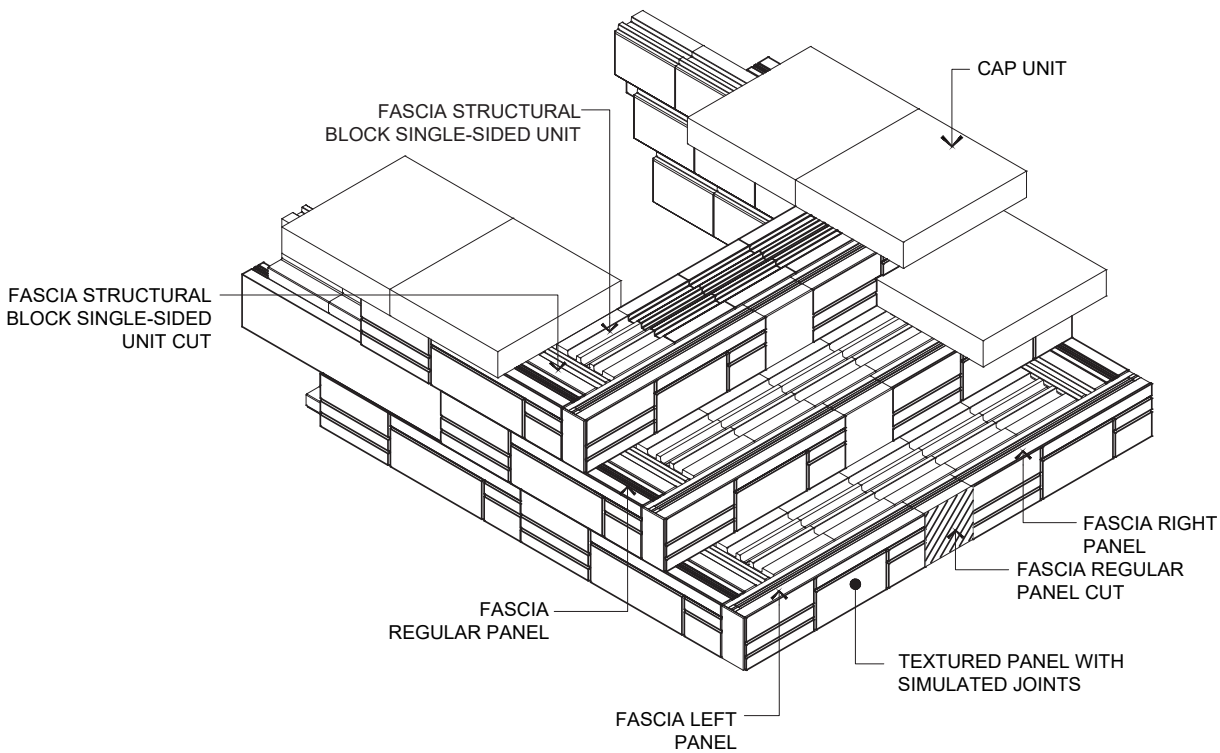
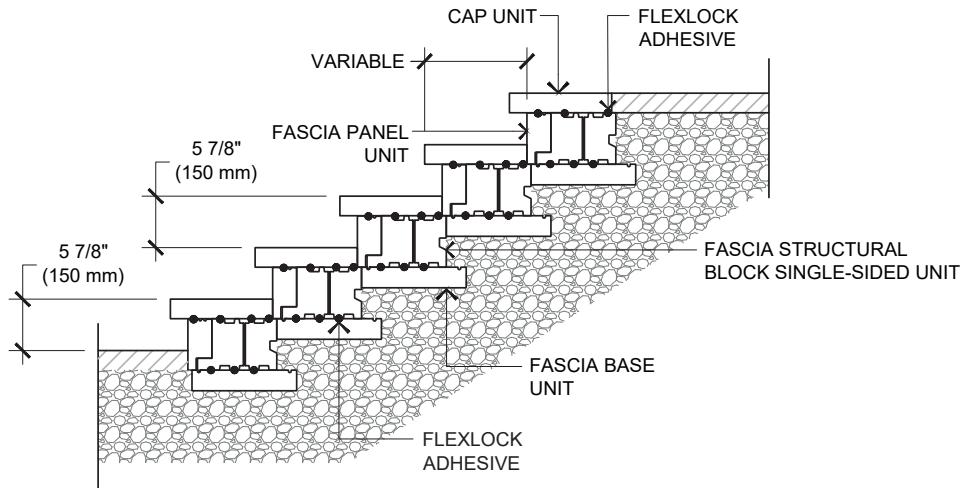

**NOTE:**

The top of Fascia Panels shall not be left exposed, they must be stabilized with a structural block on top or glued to the cap

Check with your local Building Codes to determine any restrictions or guidelines regarding the dimensions of steps (including riser height and step tread) as well as handrail specifications.