

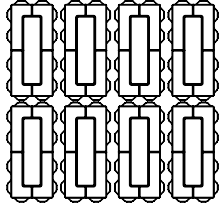

AQUASTORM

DESCRIPTION: Paver TEXTURE: Smooth

PALLET OVERVIEW



Specifications per pallet		Imperial	Metric
Cubing		78.39 ft ²	7.28 m ²
Approx. Weight		2 245 lbs	1 018 kg
Number of rows		7	
Coverage per row		11.20 ft ²	1.04 m ²
Linear coverage per row	Depth	13.39 lin. ft	4.08 lin. m
	Length	6.69 lin. ft	2.04 lin. m



Aqua Storm paver meet and exceeds the requirements of ASTM C1319 for Concrete Grid Paving Units.

Unit dimensions	in		mm		Units/pallet
	in	mm	in	mm	
Height	3 ¹⁵ / ₁₆	100			56 units
Width	10 ¹ / ₁₆	255			
Length	20 ¹ / ₁₆	510			

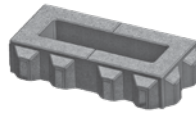

NOTES

See page 44 to 47 for more technical information. When used in a permeable pavement application, see page 89 to 95 for more technical information.

JOINT WIDTH: 1 ⁵/₈" (41 mm)
% OF SURFACE OPENING: 38 %
INFILTRATION RATE: 2 395 IN./HR
 (60 842 MM/HR)

01 | Herringbone pattern

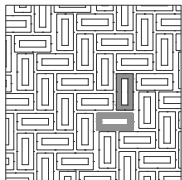

02 | Linear pattern

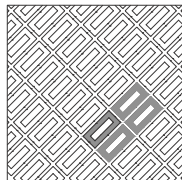

03 | Linear pattern pattern

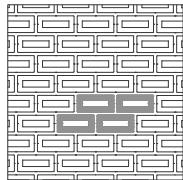

Patterns are for design inspiration only. The installer is responsible to calculate & purchase the correct amount of material.

grey

